

9to5[®]
seating

Government Seating Solutions



Contract No. GS-28F-0013X
Schedule 71, Furniture



Green Practice

9to5 Seating is committed to sustainable and environmentally responsible business practices. Responsible sourcing is a process we take very seriously. We work hard to ensure that the chairs we manufacture are safe for our customers and are produced in an environmentally and socially responsible manner. This global perspective is endorsed and executed throughout every aspect within our corporate culture, warehousing, manufacturing, and office facilities.

We are proud to demonstrate our commitment by offering GREENGUARD Certified products. Our entire product line earned GREENGUARD Gold Indoor Air Quality Certification issued by the GREENGUARD Environmental Institute. Additionally, 9to5 Seating participates in the U.S. Environmental Protection Agency's Waste Wise Program and has been awarded the prestigious LEED® NC Gold Certification for our flagship factory and corporate headquarters in Hawthorne, California. Our Hawthorne headquarters uses a solar powered rooftop photovoltaic panel system to generate electricity for the facility. This solar panel system has generated over 4,750 kWh since 2011; as a result, we have saved over 600 tons of CO₂, 15,000 trees, and 67,500 gallons of gas. To view how much power we are generating in real-time visit our solar portal at: www.9to5seating.com/solar

At 9to5 Seating, we are aware of the potential impacts that today's environmental challenges will have if they are left unaddressed. That is why we will continue to reduce our carbon footprint and strengthen our commitment to thinking and acting green. To learn more about our green practices, please visit:

www.9to5seating.com/green_statement.php



Vertically Integrated

We differentiate ourselves through vertical integration. Chairs are manufactured and shipped from our flagship factory in Hawthorne, California and many of our component parts are made in our factory located in Union City, Tennessee. Unlike our competitors who buy most of their parts from outside suppliers, we can control the consistency of raw materials used to build our products. We save time, money, and resources by doing this in house. These savings are then passed on to you.

The ingenuity in our ergonomic designs and vertical manufacturing process reflect a high level of quality and craftsmanship you can expect every time you sit in a 9to5 Seating chair. We offer quality seating built to last, which is why we stand behind our Lifetime Warranty.



CONTENTS

Task Chairs

Agent	02
Bristol	02
Brio	03
Cydia	03
Theory	04
Logic	05
Precept	05
Strata	05
Strata All Mesh	05
Vault	05

Conference / Private Office

Aria	07
Cayman	07
Cortina	07
Cosmo	07
Vesta	07

Lounge / Guest

Aria GT	08
Link	08
Cydia GT	09
Shuttle Mesh	09

Training / Multipurpose

Bella	11
Bella Mesh	11
Indy	11
Kelley	11
Shuttle	11

Special Application

Axis	12
Logic Plus	13
Enduro 24/7	13

Warranty	14
Terms & Conditions	16
State Contracts	18
Showroom Locations	20

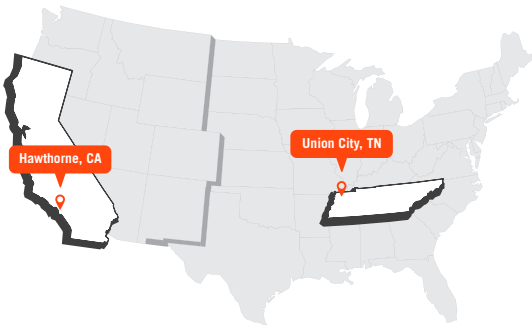

ABOUT

Founded in 1982, 9to5 Seating is a vertically integrated manufacturer, specializing in the design and production of ergonomic office seating to accommodate the rigorous demands of today’s office environments. While 9to5 Seating has many years of experience in the manufacturing of office seating, it truly differentiates itself from its competitors by its vertical integration with manufacturing facilities globally. It is through this combination of domestic and global manufacturing that we are able to offer the customer the options and the wide selection of upholstery material only available when the product is manufactured in the United States, but at prices that rival products that are totally of foreign manufacture.



TASK CHAIRS



agent

Starting at \$270

Lending comfort, durability and value to every project.

- Offers cost effective features and highly adjustable ergonomic functions
- High resilient molded foam on every seat and back
- Five control options exactly match project needs



brio

Starting at \$510

Mesh back chairs tailored to you.

- Offers advanced styling and sensible value
- Five control options to ensure a fit to every application
- Optional LB adjustable lumbar pad



bristol

Starting at \$490

Seamless integration into your office's architecture.

- Fixed and adjustable tasking arm options
- Waterfall seat front promotes circulation and good health
- High resilient molded foam seat and back



cydia

Starting at \$565

Organic design meets ergonomic excellence.

- Nature's influence is the foundation of Cydia's design, inspired from the shape of a butterfly's wings
- Organic meets light and elegant design with breathable premium mesh; now available with upholstered seat and/or back options



TASK CHAIRS

NEW



theory Starting at \$555

The facts support Theory as the smart choice.

- Backrest is height adjustable for complete ergonomic comfort
- Organic meets stylish and elegant design with breathable premium mesh or optional upholstered seat options



logic Starting at \$450

Ergonomics, quick ship, lifetime warranty and unbeatable value.

- Offers functions and ergonomics at a great price
- Optional edge protector helps minimize wear and tear from intensive use or specialized work environments



precept Starting at \$350

Breadth of configurations with unparalleled value.

- 2.5" of high resilient molded foam on seat
- Six control options ranging from basic to multi-function



strata Starting at \$485

Let Strata float into your office.

- High quality, woven tension mesh offers better lumbar support
- Waterfall seat front promotes circulation and good health
- Heavy duty synchro-tilt control features a 2:1 back-to-seat tilt ratio with four position locks.

NEW



strata all mesh Starting at \$540

Let Strata All Mesh float into your office.

- Great for managerial and executive offices
- Simple Synchro control locks back in upright position or allows it to free float
- Heavy duty synchro-tilt control features a 2:1 back-to-seat tilt ratio with four position locks.

NEW*



vault Starting at \$425

Vault goes beyond the expected.

- Ratchet back height adjustment, a first for a mesh back design, offers users the ability to raise or lower the backrest for the greatest comfort
- High quality, woven tension mesh conforms to the user's back, following

*New for headrest model only



CONFERENCE / PRIVATE OFFICE



*New for headrest model only

aria

Starting at \$470

Aria provides revolutionary comfort.

- Aria is the answer where new ways of working require new features in seating
- Suspension seat incorporates a flexible high-performance mesh with a molded high-density foam overlay and zero plywood; formaldehyde-free construction



cayman

Starting at \$675

Contemporary, ergonomic and built with attention to detail.

- Cayman's slim profile and refined European style offers a fresh look to conference rooms or executive offices
- Wide selection of upholstery over high resilient molded foam and a one piece shell



cortina

Starting at \$585

Simple, straightforward ergonomics and functionality.

- Upholstered in either fabric or leather
- Choose armless, fixed arms in polished aluminum or black polyurethane, or Ura-soft® adjustable arms



cosmo

Starting at \$815

Contemporary style, elegance and comfort.

- Slim profile and refined European style offers a fresh look to conference rooms or executive offices
- Upholstered backs create a transitional look while mesh and knit back options yield a contemporary style



vesta

Starting at \$925

Excellence in total ergonomics.

- Standard with a synchro-tilt control which provides simple, intuitive ergonomic support and comfort
- Standard two position seat tilt

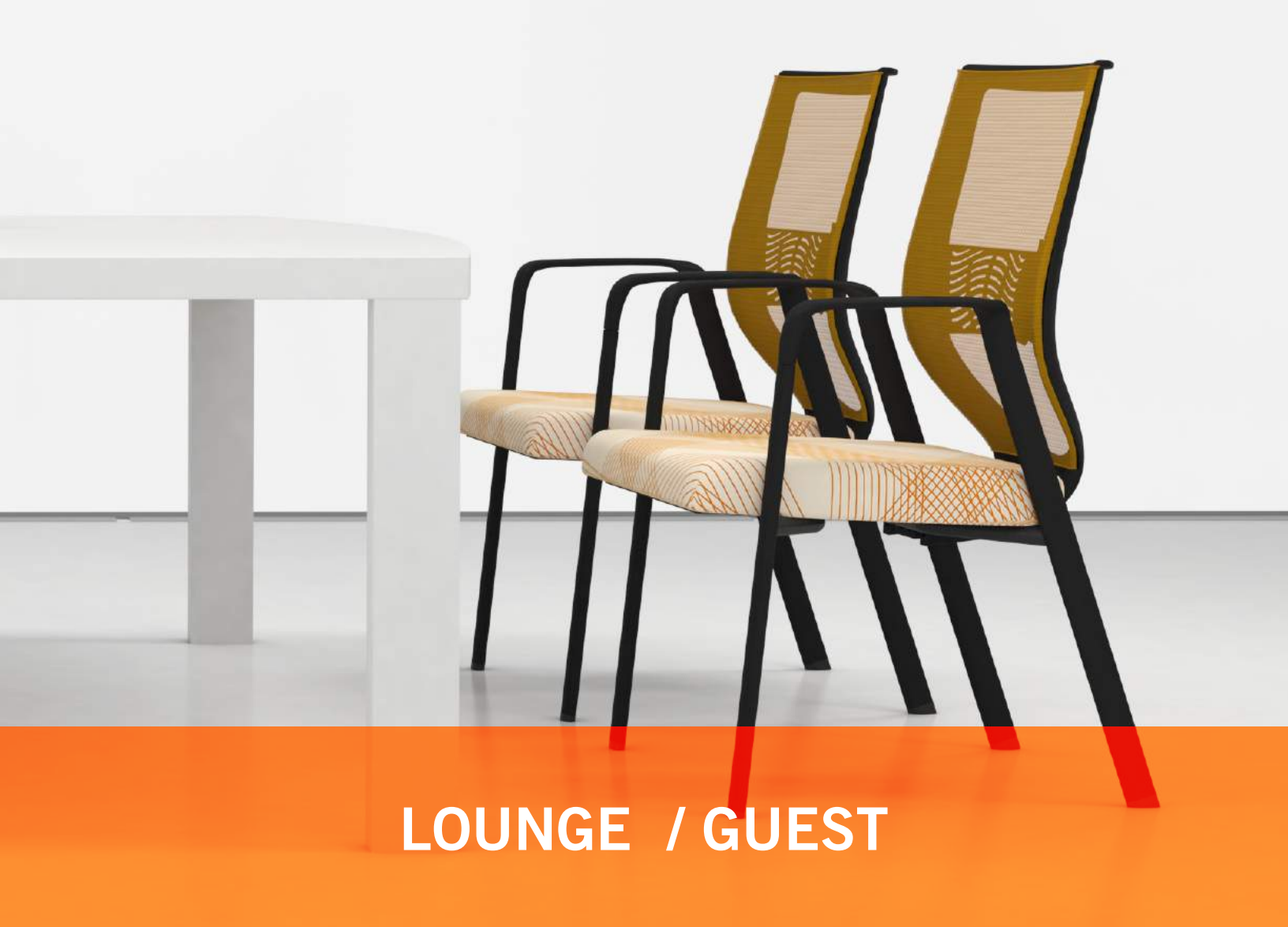

LOUNGE / GUEST



NEW*



*New for headrest model only

aria gt

Starting at \$450

Aria provides revolutionary comfort.

- Aria is the answer where new ways of working require new features in seating
- Cool and comfortable, this sleek and supportive mesh is available in eight designer colors

NEW



cydia gt

Starting at \$465

Organic design meets ergonomic excellence.

- Nature's influence is the foundation of Cydia's design inspired from the shape of a butterfly's wings
- Organic meets light and elegant design with breathable premium mesh

NEW



shuttle mesh

Starting at \$300

The ultimate mesh back utility chair.

- Available in upholstered or 11 plastic colors for seat and 19 mesh colors for back
- Available with either gray or black arms
- All models offer 300 lb weight rating



link

Starting at \$340

Transitional style with limitless possibilities.

- Wall saver leg design prevents back from touching walls
- Molded foam seat
- Convex back design provides lumbar support



TRAINING / MULTIPURPOSE



bella

Starting at \$200

Name your game, Bella is ready to play.

- Convenient handle built into every back for ease of mobility
- Choose all plastic, upholstered seat with plastic back or fully upholstered
- Four leg Bella models can be configured with an optional right hand tablet arm



bella mesh

Starting at \$265

If mesh is your game, Bella's in play.

- Mesh back provides tailored lumbar support to each user
- Optional rolling dolly for easy storage of non-nesting models



indy

Starting at \$205

Flex back movement yields superior comfort.

- Flex back provides 15 degrees of movement for user comfort
- Standard with non-marring floor glides

NEW



kelley

Starting at \$160

Nothing stacks up to the Kelley.

- Kelley is available in 11 molded colors
- Matching armrest covers
- Chrome finish in sled style wire frame



shuttle

Starting at \$235

The ultimate utility chair.

- Available in fully upholstered or 11 plastic colors for seat and back
- All models offer 300 lb weight rating
- Standard non-marring floor glides protect floor surfaces



SPECIAL APPLICATION



axis with jury base

Starting at \$820

Great design never goes out of style.

- Sleek pillowcase seat and back, upholstered in fine top-grain leather or an extensive selection of fabrics and vinyls

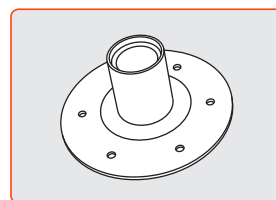

JB1

\$300

STANDARD JURY BASE

Use w/ all task models
Consists of round plate
which is bolted to floor and
receives pneumatic cylinder

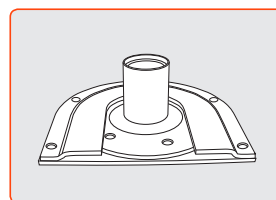

JB2

\$675

QUICK RELEASE JURY BASE

Use w/ all task models
Pedestal base with quick
release to remove chair and
cylinder (includes JB1)

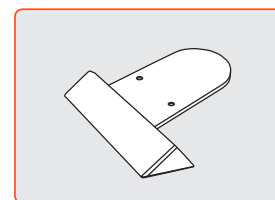

JB2-PLT

\$100

RAMP INSERT FOR
JB2 JURY BASE

Use w/ JB2 Insert when
chair & cylinder removed
for ADA compliance



logic plus big & tall

Starting at \$790

Logic Plus is the logical choice with an unbeatable value.

- Logic Plus is warranted up to 500 lbs
- 25" Wide Seat offers ample room and complete comfort
- Additional durability options include ballistic nylon upholstery or edge protector which helps minimize wear and tear from intensive use or specialized work environments



enduro 24/7

Starting at \$685

Designed for 24/7 multi-shift use, Enduro holds strong.

- Handles demanding 24/7 multi-shift requirements
- Heavy duty synchro-tilt or multi-function control
- Molded high resilient foam is used on every seat and back for ergonomic support and durability



WARRANTY

9to5 Seating products are manufactured with meticulous attention to detail to achieve a level of quality that is free from defects in material and workmanship. In an effort to stand behind this philosophy, 9to5 Seating warrants to the original user of the product and from the original date of purchase, the following:

- With the exception of products noted below Lifetime Warranty to the original end user, the company will repair or replace, at its option, without charge to the original purchaser only, factory defective structural and mechanical parts. This warranty is for single shift, standard commercial usage, defined as a standard 8 hour work day, five days a week. Weight limitations vary by product.
- Upholstery fabric and foam is warranted against wear through and deterioration during normal usage for a period of five (5) years. However, the company does not warrant leather against routine scratching and scuffing, as all leather is subject to minor blemishes during use. COM and COL are not warranted. Due to natural variations in material, furniture containing leather is sold subject to normal variations and/or irregularities of color, texture, and grain.

For Logic Plus™, Enduro™ and Strata™ Heavy Duty Series, please contact 9to5 Seating.

Should parts fail for any model during normal use within the applicable warranty period, please provide 9to5 Seating with a description of the failure and proof of purchase (Sales Order number located on the bottom of the chair) and if necessary you may need to return the defective part, freight prepaid to 9to5 Seating for inspection, repair and/or replacement, together with a copy of original sales receipt. Labor and installation service is not covered under warranty. Please do not send parts without prior authorization.

Send parts to:

9to5 Seating - Warranty Department
3211 Jack Northrop Avenue
Hawthorne, CA 90250

9to5 Seating will inspect the part in question, repair or replace at its option any defective part at no charge and return to the original purchaser.

This warranty does not apply to product or parts of product that have been subjected to misuse or abuse, accident, alteration, unauthorized repair or which have been damaged in transit. You agree to indemnify and hold harmless 9to5 Seating, its officers, directors, shareholders, employees, and agents from any actions, claims, demands, damages, liabilities, costs, and strict liability in tort or contract, or any other legal theory arising out of the misuse or abuse, alteration, or damage in transit of the product.

Limitation of Liability

Under no circumstance, including but not limited to breach of contract, breach of warranty or negligence, shall 9to5 Seating be liable for lost profits, loss of goodwill, stored data, general, special, consequential or exemplary damages, even if 9to5 Seating had notice of these damages or they were foreseeable. 9to5 Seating shall not be responsible for verifying dealer's or customer's description of needs, data, or the fitness for a particular purpose of goods. 9to5 Seating's Liability in all cases shall be limited to repair or replacement of the defective parts, or the purchase price of the product. Damages resulting from misuse, abuse, alteration, negligence, or accidents are not covered under this warranty. 9to5 Seating makes no warranty that any of its products are suitable for any particular purpose and makes no other warranties, express or implied, other than those set out here. As codes and standards vary from one jurisdiction to another, references to compliance are solely for convenience and without any representation as to accuracy or suitability. Users must verify the suitability of such information or product for their specific application. In no event shall 9to5 Seating be liable in either tort or contract for any loss or direct, special, incidental, consequential, or exemplary, damages.

ANSI/BIFMA

The Business and Institutional Furniture Manufacturer's Association (BIFMA) has developed tests which have been approved by the American National Standards Institute (ANSI) for determining the strength and durability of seating in its everyday use. This statement does not serve as a warranty or guarantee, however 9to5 Seating products found within this price list generally meet or exceed applicable BIFMA and ANSI standards.

For complete text of warranty, please call 9to5 Seating at: 1.888.925.SEAT

EXCEPT AS OTHERWISE PROVIDED, 9TO5 SEATING MAKES NO OTHER WARRANTIES, EXPRESS OR IMPLIED, INCLUDING BUT NOT LIMITED TO THE WARRANTIES OF MERCHANTABILITY AND FITNESS FOR A PARTICULAR PURPOSE.



TERMS & CONDITIONS

GSA CONTRACT: **GS-28F-0013X** D3 Inc. d/b/a 9to5 Seating

CONTRACT PERIOD: 24 February 2011 thru 23 February 2021

CLASSIFIED: SMALL BUSINESS

1a	Special Item Number	SIN 711-18Multipurpose Seating (Sequence Model 2400 not available on Contract) SIN 711-19Stacking Chairs		
1b	Lowest Priced Items	SIN 711-18Agent 1425-B2-00 SIN 711-19Indy 1010-GT-AP	<u>44 States and DC</u> \$96.29 \$74.67	<u>Western States</u> \$84.04 \$65.17
2	Maximum Order Limitation	\$100,000 (net) SINS 711-18 and 711-19		
3	Minimum Order	\$100.00 (net)		
4	Geographic Coverage	48 CONUS and Washington DC		
5	Point of Production	Hawthorne, CA 90250		
6	Discount	60.7% off list for 44 States and District of Columbia 65.7% Western States (AZ-CA-NV-OR-UT-WA)		
7	Single Order Quantity Discount	Contact 9to5 Seating		
8	Prompt Payment Terms	NET 30 Days		
9a	Government Purchase Cards	Accepted at or below the micro-purchase threshold.		
9b	Government Purchase Cards	Accepted above the micro purchase threshold.		
10	Foreign Terms	Not Available		
11a	Time of Delivery	10 - 60 days A.R.O.		
11b	Expedited Delivery	Items noted as “5 day Quick Ship” ship in 5 business days A.R.O.		
11c	Overnight and 2-Day Delivery	Available for select orders with an additional charge		
11d	Urgent Requirements	Contact 9to5 Seating		
12	FOB Point	Origin, Dock to Dock shipment Prepaid and Allowed		

13a	Ordering Address	D3 Inc. d/b/a 9to5 Seating (c/o Authorized Dealer if applicable) 3211 Jack Northrop Ave Hawthorne, CA 90250 Phone: 888-925-SEAT (7328) Fax: 866-925-SEAT (7328) Email: sales@9to5seating.com		
13b	Ordering Procedures	For supplies and services, Ordering procedures and information on Blanket Purchase Agreements (BPA's) are found in Federal Acquisition Regulation (FAR) 8.405-3.		
14	Payment Address	D3 Inc. d/b/a 9to5 Seating 3211 Jack Northrop Ave Hawthorne, CA 90250		
15	Warranty	9to5 Seating's Limited Lifetime warranty to the original end user. This warranty is for single shift, standard commercial usage, defined as a standard eight (8) hour work day, five (5) days a week, when the product is used by a person weighing less than 250 lbs. See Price list for more details.		
16	Export Packing Charges	N/A		
17	Terms of Government Commerical Credit Card Acceptance	Visa and Mastercard Accepted		
18	Rental, Maintenance, and Repairs Terms	N/A		
19	Installation Terms	Contact 9to5 Seating		
20	Repair Parts, Etc.	See Warranty. Contact 9to5 Seating		
21	List of Service and Distribution Points	Contact 9to5 Seating		
22	List of Participating Dealers	Contact 9to5 Seating		
23	Preventative Maintenance	Contact 9to5 Seating		
24a	Environmental Attributes	ALL CHAIRS GREENGUARD CERTIFIED AND Recycled Upholstery Material Available.		
24b	Section 508 Compliance	N/A		
25	DUNS: 13-331-7214	Fed ID: 20-1545013	Cage Code: 5G4S4	
26	Registration in Central Contract Registration (CCR) Database	D3 Inc. d/b/a 9TO5 Seating is registered.		

Restocking Charge: Merchandise may not be returned without prior written consent. Returns are subject to a 35% of NET plus freight charges.

Cancellation Charges: There will be no cancellation charges prior to production. After production, actual cost incurred will be assessed if product can not be sold after a reasonable length of time.

STATE CONTRACTS

State	Contract #	Dates Valid
Alabama	4011927 T-Number:T390	12/01/2011 to 11/30/2016
Arkansas	SP-13-0230R	01/01/2016 to 12/31/2016
California Multiple Award Schedule (CMAS)	4-15-71-0144A	02/04/2015 to 05/31/2016
Connecticut	15PSX0041	07/01/2015 to 06/30/2020
Delaware	Please contact our local representative for all terms, conditions, pricing and participating dealers	
Massachusetts Higher Education Consortium	MC11-C07 Furniture	07/01/2015 to 06/30/2018
Mississippi	1130-15-C-SWCT-00727	07/01/2015 to 06/30/2016
New Jersey	A81702	07/30/2012 to 07/31/2017

STATE CONTRACTS

State	Contract #	Dates Valid
North Carolina	201400059	07/01/2015 to 12/31/2016
University of Oklahoma	R-16000-16	07/01/2015 to 06/01/2016
Pennsylvania COSTARS	COSTARS-035-051	09/04/2012 to 09/04/2016
South Carolina	4400005940	12/05/2012 to 12/04/2017
Texas Multiple Award Schedule	TXMAS-15-7102	09/12/2014 to 02/23/2016
Wisconsin	505ENT-M15-OFFURNITUR-09	07/10/2015 to 07/10/2016
NCPA	07-15	10/01/2015 to 10/31/2018
Choice Partners	15/031CG-01	07/21/2015 to 07/20/2016

SHOWROOM LOCATIONS



Southern California
Los Angeles Showroom
3211 Jack Northrop Avenue
Hawthorne, CA 90250
Managed by 9to5 Seating
Call for appointment 310.220.2500



Northern California
San Jose Showroom
2528 Qume Drive, Suite 6
San Jose, CA 95131
Managed by Linked
Call for appointment 925.786.0178

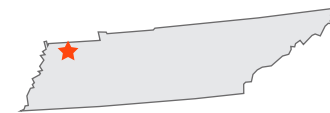

Tennessee
Union City Showroom
3919 Greenfield Dr
Union City, TN 38261
Managed by 9to5 Seating
Call for appointment 310.220.2500



Illinois
Chicago Merchandise Mart Showroom
222 W. Merchandise Mart Plaza
10th Floor, Suite 10-109
Chicago, IL 60654
Managed by 9to5 Seating
Contact: Milica Vidovich
Call for appointment: 312.617.6067

SHOWROOM LOCATIONS



Texas
Dallas Showroom
150 Turtle Creek Blvd, Ste. 106
Dallas, TX 75207
Managed by Tackett & Associates
Contact: Paul Tackett, Sara Tackett
Call for appointment: 972.800.8778



Georgia
Atlanta Showroom
2135-A Defoor Hills Road
Atlanta, GA 30318
Managed by Southeast Contract Sales
Contact: Bryan Durkis, Todd Krutz, Jillian Florence
Call for appointment: 678.516.5766



Arizona
Phoenix Showroom
4001 E. Broadway Suite 8
Phoenix, AZ 85040
Managed by J.B. Smith & Associates
Contact: Brett Smith
Call for appointment: 602.908.2898

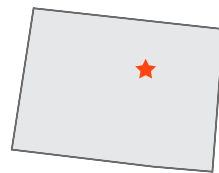

Colorado
Denver Showroom
1601 Arapahoe Street, 12th Floor
Denver, CO 80202
Managed by The Skinner Group
Contact: Chuck Skinner, Jill Skinner
Call for appointment: 303.688.6464



Visit our website at www.9to5seating.com
or scan below:

